

Lugus HOMES



Nine Elms Lane, London

£2,750 Per month



A well-proportioned one-bedroom apartment set within the popular Riverside Court development, offering approximately 729 sq. ft. of internal living space and stunning views over the River Thames.

The property comprises a spacious double bedroom with access to a large private terrace enjoying direct river views, a bright and airy reception room ideal for entertaining, and a modern open-plan kitchen featuring a central island/breakfast bar, creating an excellent space for dining and socialising.

The apartment is currently undergoing a comprehensive refurbishment programme, including full redecoration throughout, upgrades to the kitchen and bathroom and the installation of brand-new kitchen appliances.

Further benefits include an allocated parking space, porter service, and heating and hot water included within the service charge.

Ideally located within easy reach of Vauxhall, Nine Elms, and the iconic Battersea Power Station, the property offers excellent transport links, a vibrant selection of restaurants, cafés, and riverside amenities.



Area Map



Floor Plans

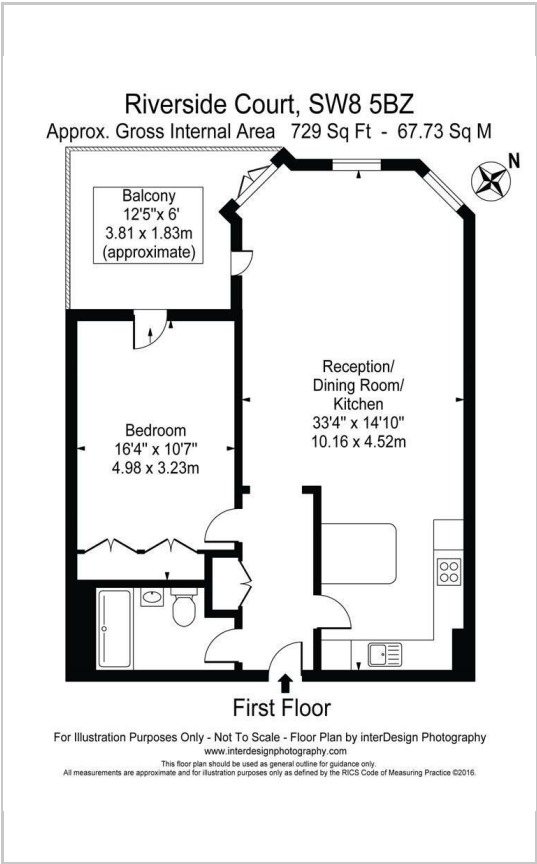

Energy Efficiency Graph

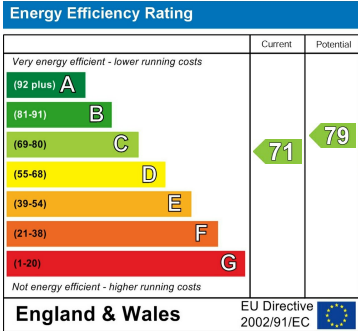

These particulars, whilst believed to be accurate are set out as a general outline only for guidance and do not constitute any part of an offer or contract. Intending purchasers should not rely on them as statements of representation of fact, but must satisfy themselves by inspection or otherwise as to their accuracy. No person in this firm's employment has the authority to make or give any representation or warranty in respect of the property.

24 Lower Downs Road, Raynes Park, London, SW20 8QG
 Tel: 07787 560885 Email: info@lugushomes.co.uk lugushomes.co.uk